

RS II VSTD

Packed full of performance and technology



- Energy savings: **up to 75% on electricity consumption**
- **Appreciable acoustic comfort** during low-speed operating phases
- **Simple, intuitive digital interface**
- 4 digital inputs to allow the pump to be operated by an external controller
- **180° rotary box for convenient access to the user interface**
- **New connection box** for easier electrical connection
- **Quarter-turn opening cover** for easy maintenance
- **Union fittings provided** to ensure ease of installation

YEARS OF WARRANTY



CONFIG



<http://www.hayward-pool.co.uk/services/toolbox>



Intuitive display of relevant information such as real-time energy consumption. Possibility of five daily programmes. Skimming function to skim the surface automatically every 1, 2 or 3 hours.
Timer mode



Rotary box for easy access to the interface in very small equipment rooms.

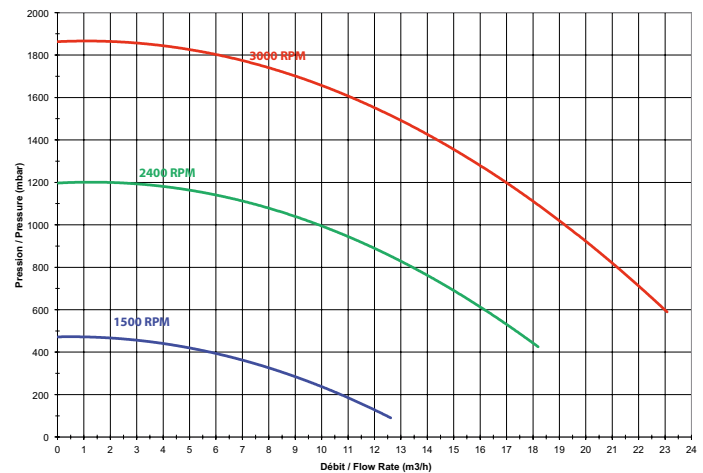

RS II VSTD

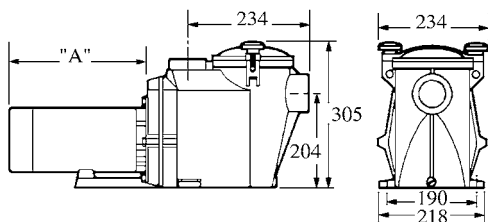

	Speed	Type	I/O	Water flow rate*	Power input P1	Power output P2	Amperage *	Ref.
RS II VSTD	600 - 3000 RPM (par 20 rpm)	1,5 cv	63 mm	@10 m : 21 m³/h @8 m : 19 m³/h	1 340 W	1 100 W	@10 m : 5,63 @8 m : 5,66	RS3016VSTD

**at 8 m water column and 3000 rpm